

PORTABLE WIRELESS A4 PRINTER

A4 Tattoo Sencil Printer Series



Please read the instruction manual carefully before using the product.

Version:1.0

01.Item Checklist

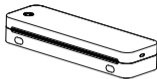

Printer*1



Type-C Cable*1



Type-C to USB*1
(For Mac)



Transfer Paper*1



Roll Paper*1
(In printer)



Instruction Manual*1

02.Specifications

Name	Portable Wireless A4 Printer
Model	A40s
Supported consumable	Transfer Paper, Rolled Thermal Paper, Fold Thermal Paper(Black mark)
Resolution	203dpi
Communication Port	USB,Bluetooth
Power	Type-C 5V $\overline{\text{---}}$ 2A
Product Dimensions	265.6x80x48mm(10.5*3.1*1.9inch)

03.Product Introduction

1 Power button and indicator light

- Press and hold 2 seconds to turn on/ off.

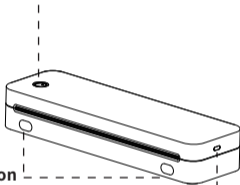

2 Paper change button

- Press the buttons at the same time to open cover and exchange paper.

3 Type-C Port

- Charged with mobile phone charger or power bank.
(Input Power:5V = 2A)
- Connect the printer with computer to print.

4 Paper limiter

- Adjust the paper limiter to fit your paper width .
paper width: 57to 216mm(2.24to 8.5 inch)

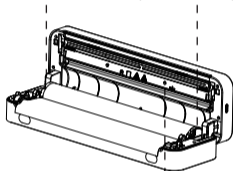

5 Reset key

- When the printer is not responding, try inserting the needle/toothpick into the reset hole for 3 seconds until the power indicator light goes off and the device shuts down. If needed, press and hold for 2 seconds to turn on the device.

04.Charging Introduction

- Please connect one end of the included USB cable to the device and the other end to a 5V \equiv 2A adapter or computer USB port for charging;
- Charge time: about 3 hours;
- We recommend you to use Mobile phone chargers for charging;
- If not used for a long time, please charge once every 3 months to avoid long-term natural loss of lithium battery can not be charged.

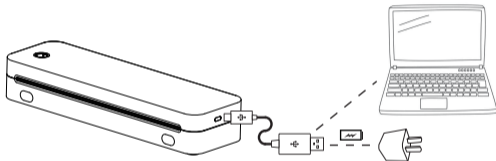

NOTE

- Working environment: Use at the ambient temperature of 5°C~40°C;
- Caution! This product doesn't contain power adapter. If consumers use a power adapter for power supply, please buy a power adapter that has obtained CE and FCC certification and meets the standard requirements. The output specifications of the adapter shall comply with 5V \equiv 2A.

05.How to Use Usage Overview



① Software Download



② Printer Startup



③ Connected Printer



④ Installation Consumables



⑤ Edit Print

05.How to Use ① Software Download

App Download (If you want to print with your phone)

Method 1: Search for [AiYin] on Google Play or App Store.



Method 2: Scan the following QR code to download App.



NOTE

- This product needs to be connected to the printer in the App;
- Due to the requirements of mobile phone system, the Android mobile phone will use the user's geographic location when connecting, so that the user needs to turn on the GPS and confirm the authorization;
- This app only supports phones with Android 7.0 or iOS 11.0 or above systems.

05.How to Use ② Printer Startup

Press and hold the power button of the printer for 2 seconds to turn on the printer.

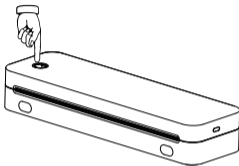

Indicator Light

Light	Functions
Light steady on	Bluetooth connected
Light flashing slowly	Bluetooth disconnected
Green light on	Normal use status /Full charged
Red light on	Cover opened/No paper/Over-heat
Yellow light on	Low battery,please charge in time.
Yellow light flashing quickly	Charging

Power Button Description

Button	Operation	Functions
Power button	Hold for 2 seconds	Power on/off
	Press once	Termimate Printing
	Press twice	Print diagnostic page and the QR code to connect the printer with smart phone App



NOTE

Auto power off:The printer will automatically power off after 20 minutes without operation.
You can set the timer in the App.

05.How to Use ③ Connected Printer

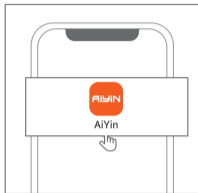

① Open AiYin App.



② Click to search for printer Bluetooth and connect.
or scan the device connection QR code by printing
from printer after double clicking the power button.

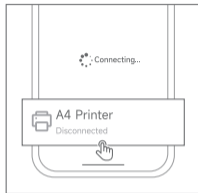

NOTE

- When connecting device in the App, please make sure that your printer is turned on and Bluetooth of your mobile phone is turned on;
- Due to the requirements of mobile phone system, the Android mobile phone will use the user's geographic location when connecting, so that the user needs to turn on the GPS and confirm the authorization;
- Please pair Bluetooth in the app, do not pair Bluetooth in the phone settings;
- If you need a PIN code, please enter 0000.

Transfer Paper Installation Guide (Make sure you have selected this type of paper in the APP)

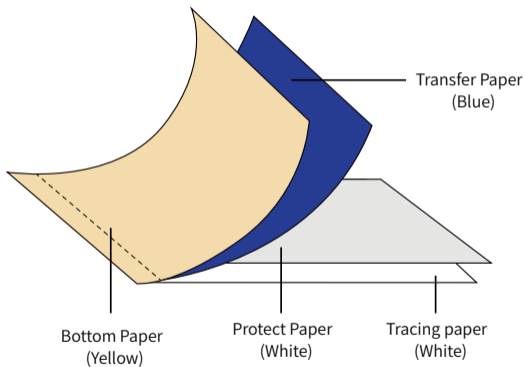

To ensure printing with high quality, please refer to the following steps:

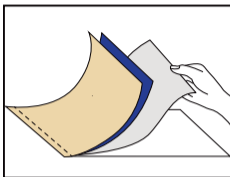

❶ Remove the protect paper.

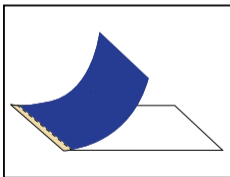

❸ The paper is ready with remaining blue transfer paper and tracing paper.

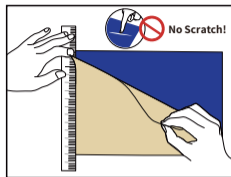

❷ Detach the bottom paper horizontally. Ensure no damage to the blue transfer paper.

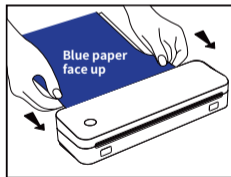

❹ Insert the paper from the back into the printer. The blue transfer paper must be facing up.

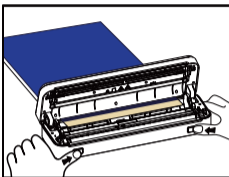

- 5 Press paper change buttons at once and open the cover.

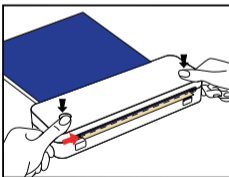

- 7 Close the cover and **make sure the edge of blue transfer paper in line with the paper cutter.**

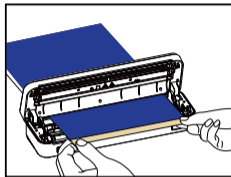

- 6 Pull the paper forward till the end of yellow bonding part just out of the paper cutter.



Scan the QR code below for a tutorial on how to print a tattoo with your printer.

Roll Paper Installation Guide (Make sure you have selected this type of paper in the APP)

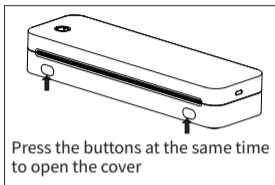

① Open the cover

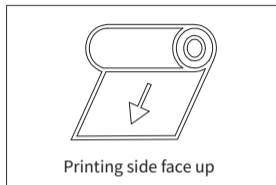

② Roll paper direction

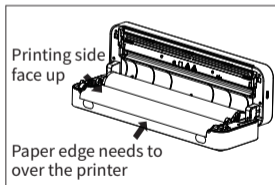

③ Load paper

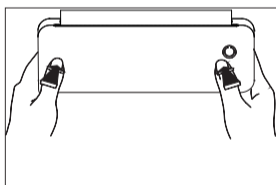

④ Press to close the cover

Fold Paper Installation Guide (Make sure there is no roll paper in the printer and select that type of paper in the APP)

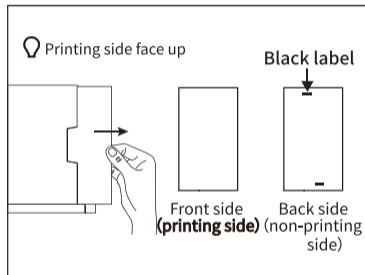

① Take out paper

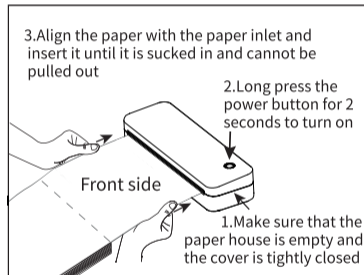

② Loading paper

Fold Paper Installation Guide

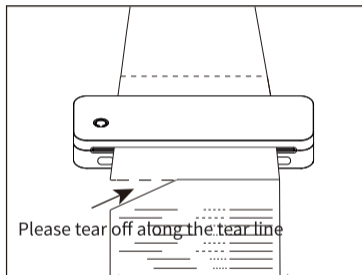

③ Tear paper

Paper Limiter Usage Method

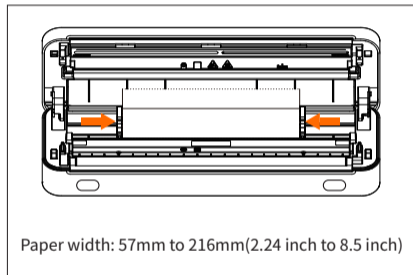

Adjust the paper limiter to fit your paper width

05.How to Use ⑤ Edit Print

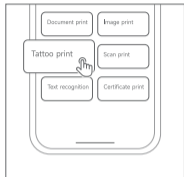

① Open the App and select Tattoo print.

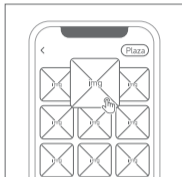

② Select picture.



③ Picture editor.

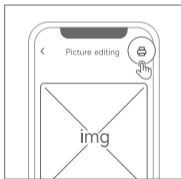

④ Click the print after editing.

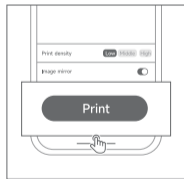

06.Clean the Printer Head

- 1 Please turn off the printer and open the printer cover and take out the paper.
- 2 Dip a cotton cloth or cotton swab with medical alcohol, and wipe gently along the center to the periphery of the printer head.
- 3 After cleaning the printer head, do not use the printer immediately. Please wait for 1 to 2 minutes, and then use the printer after the alcohol has completely evaporated.

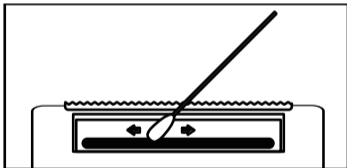

NOTE

- Please do not directly touch the printing head to avoid damage. Especially, do not directly touch the printing head immediately after printing to avoid overheating and scalding.

07.FCC Warning

This device complies with part 15 of the FCC Rules.Operation is subject to the following two conditions:

- (1)This device may not cause harmful interference,and
 - (2)this device must accept any interference received,including interference that may cause undesired operation.
- Any Changes or modifications not expressly approved by the party responsible for compliance could void the user's authority to operate the equipment.

This equipment has been tested and found to comply with the limits for a Class B digital device,pursuant to part 15 of the FCC Rules.These limits are designed to provide reasonable protection against harmful interference in a residential installation.This equipment generates uses and can radiate radio frequency energy and,if not installed and used in accordance with the instructions,may cause harmful interference to radio communications. However, there is no guarantee that interference will not occur in a particular installation.If this equipment does cause harmful interference to radio or television reception,which can be determined by turning the equipment off and on,the user is encouraged to try to correct the interference by one or more of the following measures:

- Reorient or relocate the receiving antenna.
- Increase the separation between the equipment and receiver.
- Connect the equipment into an outlet on a circuit different from that to which the receiver is connected.
- Consult the dealer or an experienced radio/TV technician for help.

The device has been evaluated to meet general RF exposure requirement.The device can be used in portable exposure condition without restriction.

08.IC Warning

IC Caution:

Radio Standards Specification RSS-Gen, issue 5-English:

This device contains licence-exempt transmitter(s)/receiver(s) that comply with Innovation, Science and Economic Development Canada's licence-exempt RSS(s). Operation is subject to the following two conditions:

This device may not cause interference.

This device must accept any interference, including interference that may cause undesired operation of the device.

RF exposure statement:

The device has been evaluated to meet general RF exposure requirement. The device can be used in portable exposure condition without restriction.

-French:

Cet appareil contient des émetteurs /récepteurs exemptés de licence conformes aux RSS (RSS) d'Innovation, Sciences et Développement économique Canada. Le fonctionnement est soumis aux deux conditions suivantes:

Cet appareil ne doit pas causer d'interférences.

Cet appareil doit accepter toutes les interférences, y compris celles susceptibles de provoquer un fonctionnement indésirable de l'appareil. Déclaration d'exposition RF:

L'appareil a été évalué pour répondre aux exigences générales d'exposition aux RF.

L'appareil peut être utilisé dans des conditions d'exposition portable sans restriction.

Warranty Card

Return

Exchange

Repair

User Info	Name: Gender: Phone:
	Address:
Product Info	Purchase date:
	Product order number:
	Product Serial Number:
Requirements of return /replacement /repair	Reason description:
Maintenance records	Failure condition: Maintenance person:
	Handling situation: Delivery date:
	Maintenance ticket number: Delivery date: